

Luggage Carrier Cross Rail Kit Installation

Installation Instructions Part Number

84877350

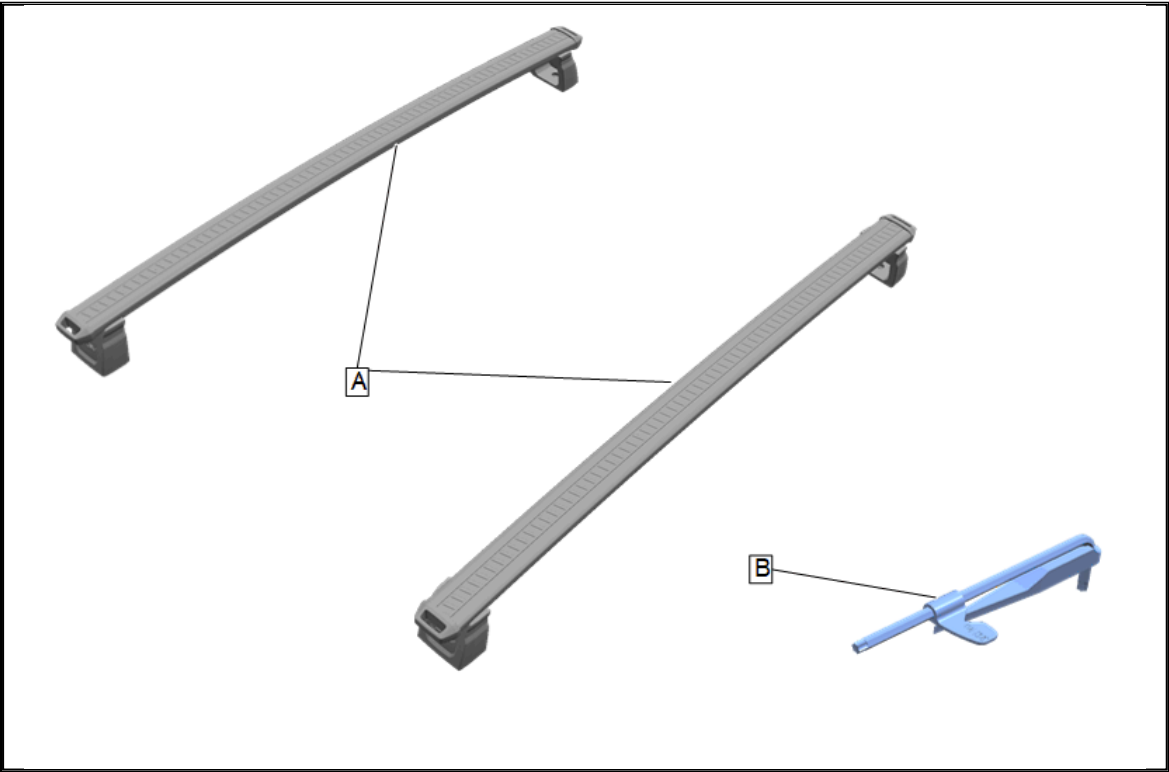

Kit Contents

Item	Qty	Description
A	2	Cross Rails
B	1	M8 Torx Wrench
—	1	Installation Instructions

Warning: The load you are carrying plus the weight of the Crossbars must not exceed the maximum weight limitation of 220 lbs (or 100 kg).

Warning: After removing the Cross Bars from the vehicle, re-install the bolts on to the compression plates to prevent water intrusion into the vehicle.

Caution: Use the correct fastener in the correct location. Replacement fasteners must be the correct part number for that application. Fasteners requiring replacement or fasteners requiring the use of thread locking compound or sealant are identified in the service procedure. Do not use paints, lubricants, or corrosion inhibitors on fasteners or fastener joint surfaces unless specified. These coatings affect fastener torque and joint clamping force and may damage the fastener. Use the correct tightening sequence and specifications when installing fasteners in order to avoid damage to parts and systems.

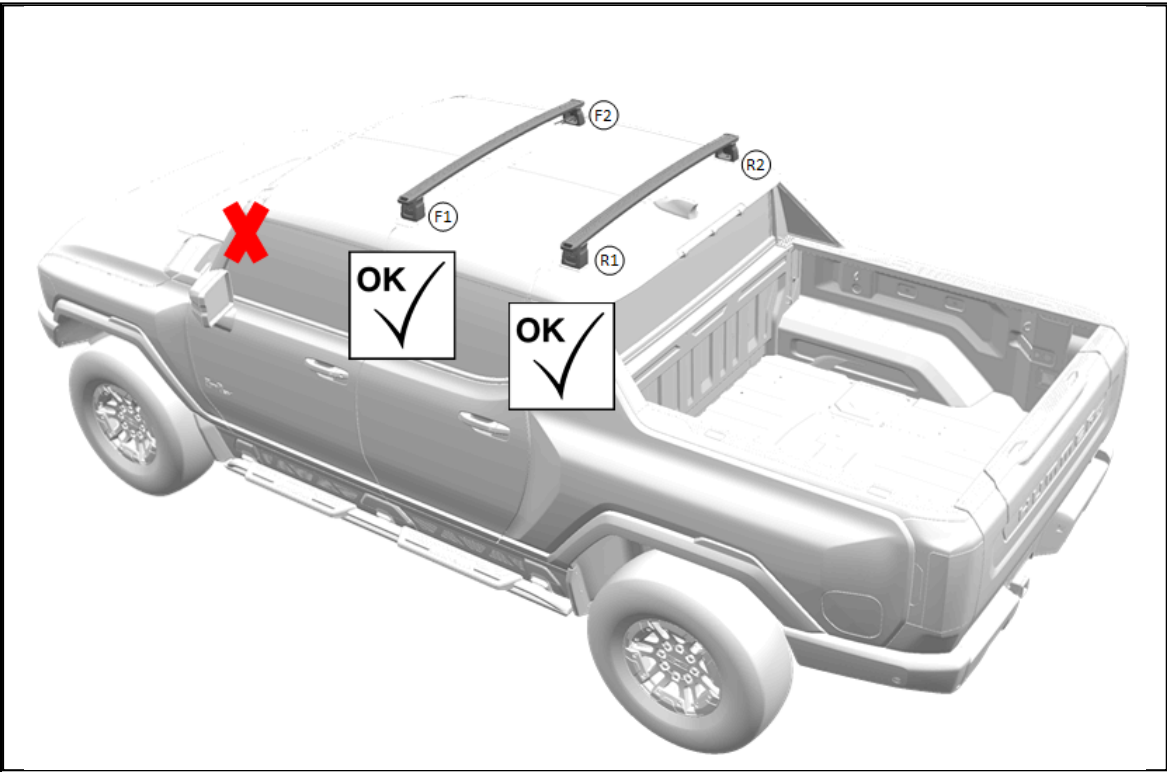

Roof cross rail kit is installed on roof compression plates.

Procedure

1. Remove the rear roof panel for easier installation if necessary. Refer to [Roof Lift Off Panel Replacement](#) in Vehicle Service Manual.

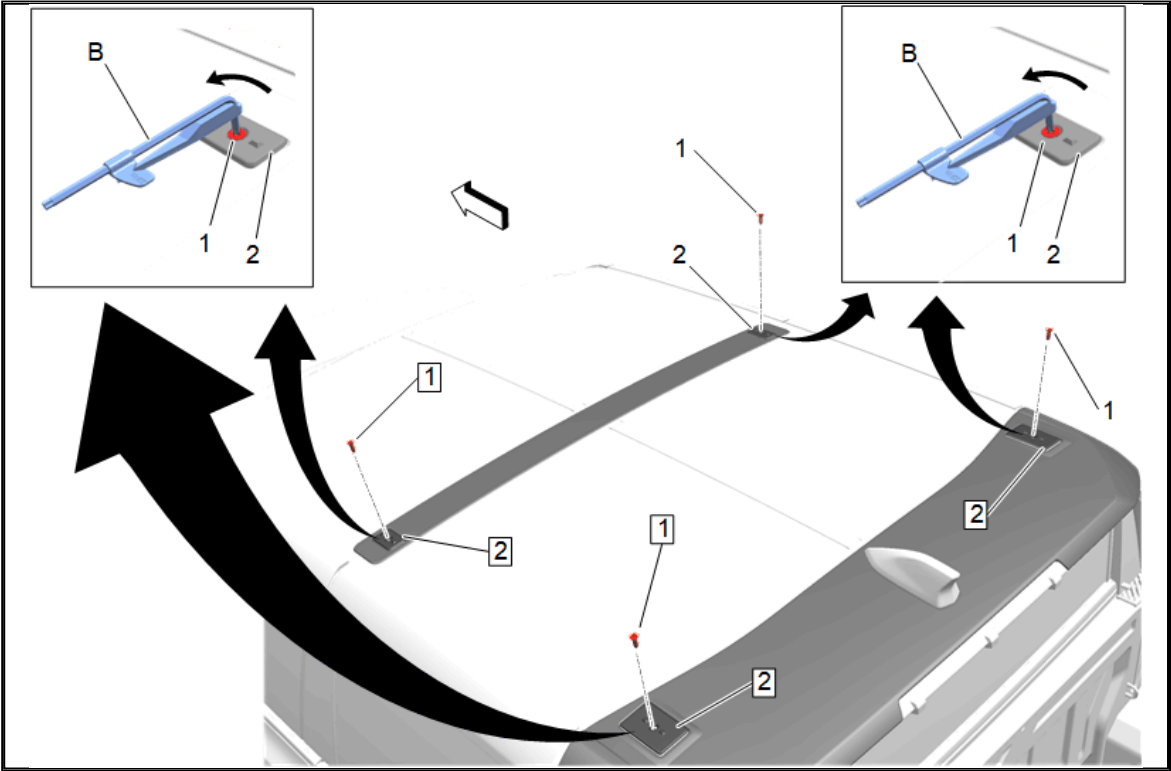

2. Using the M8 Torx wrench (B) remove four M8 screws (1) from the four compression plate locations (2). Save the screws to be reused in steps 4 and 6.

Note: Do not remove the compression plates (2) from the vehicle.

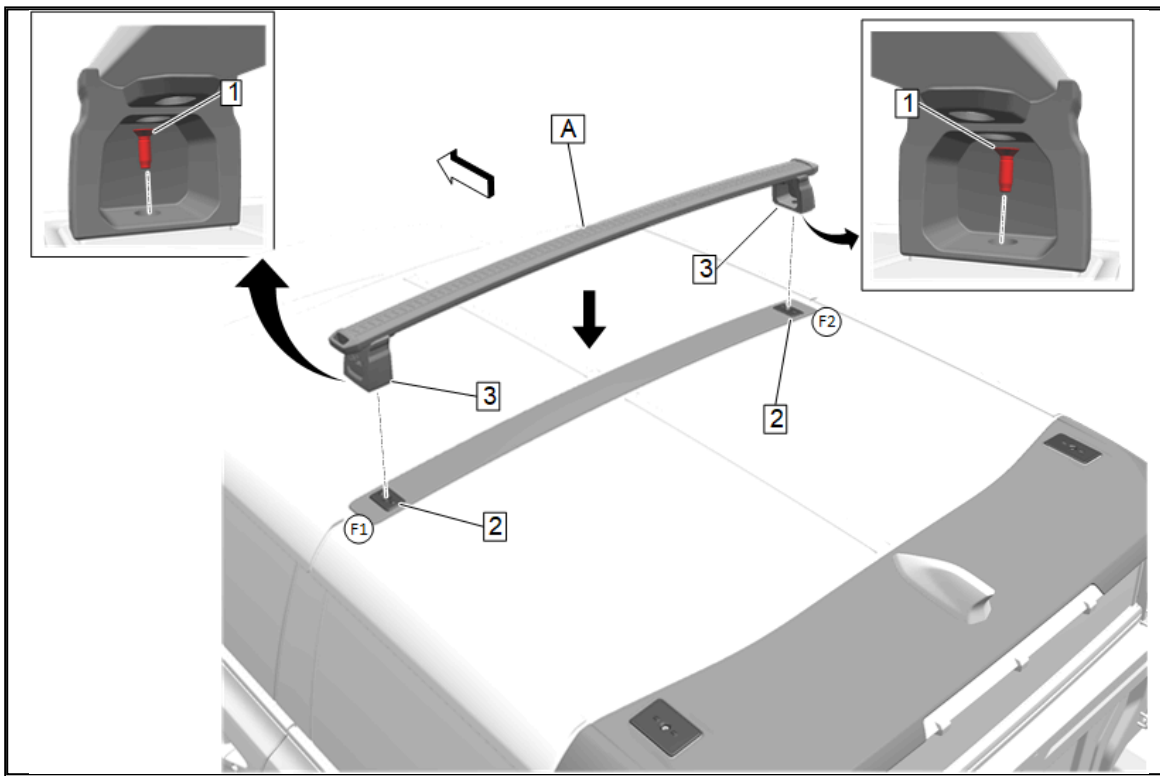

3. Carefully position the first cross rail (A) on the compression plates (2) at positions F1 and F2 with the sliding side of the cross rail stanchion (3) on the passenger side of the vehicle.
4. Use the M8 screws (1) from (step2) to align the holes on the cross-rail stanchion (3) and the compression plate (2). Hand tighten the M8 screws at this time.

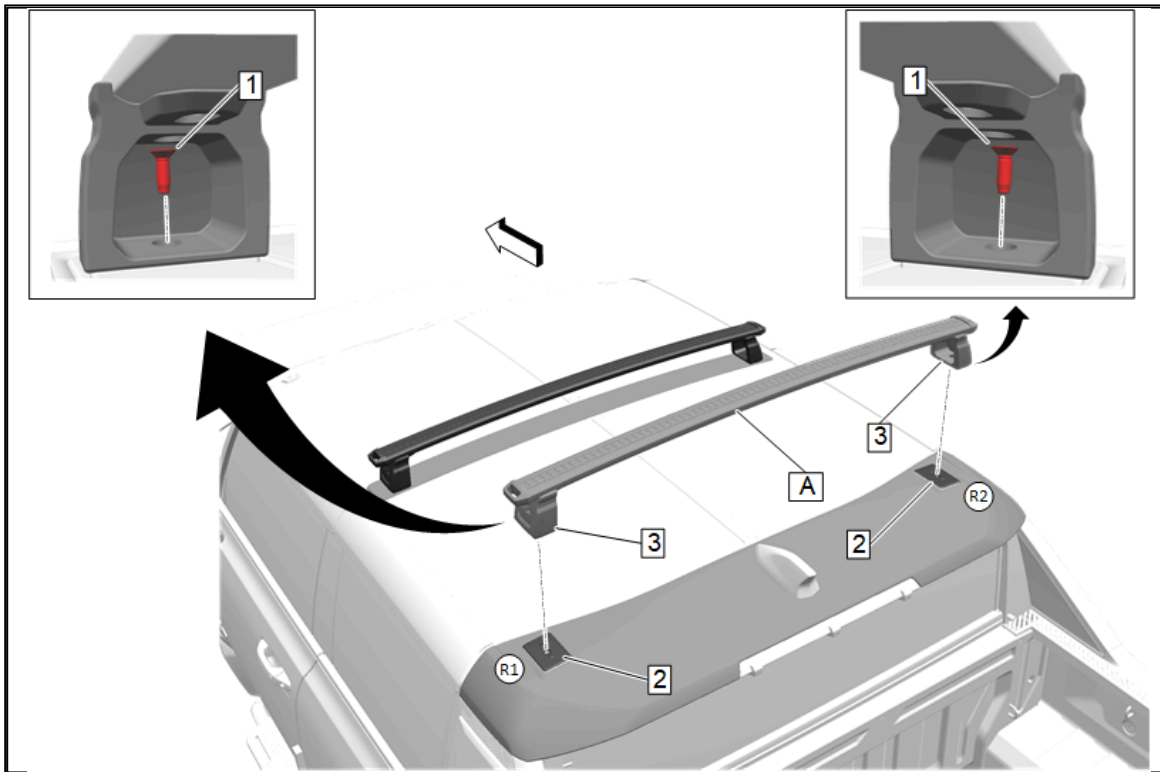

5. Carefully position the second cross rail (A) on the compression plates (2) at positions R1 and R2 with the sliding side of the cross rail stanchion (3) on the passenger side of the vehicle.
6. Use the M8 screws (1) from (step2) to align the holes on the cross-rail stanchion (3) and the compression plate (B). Hand tighten the M8 screws at this time.

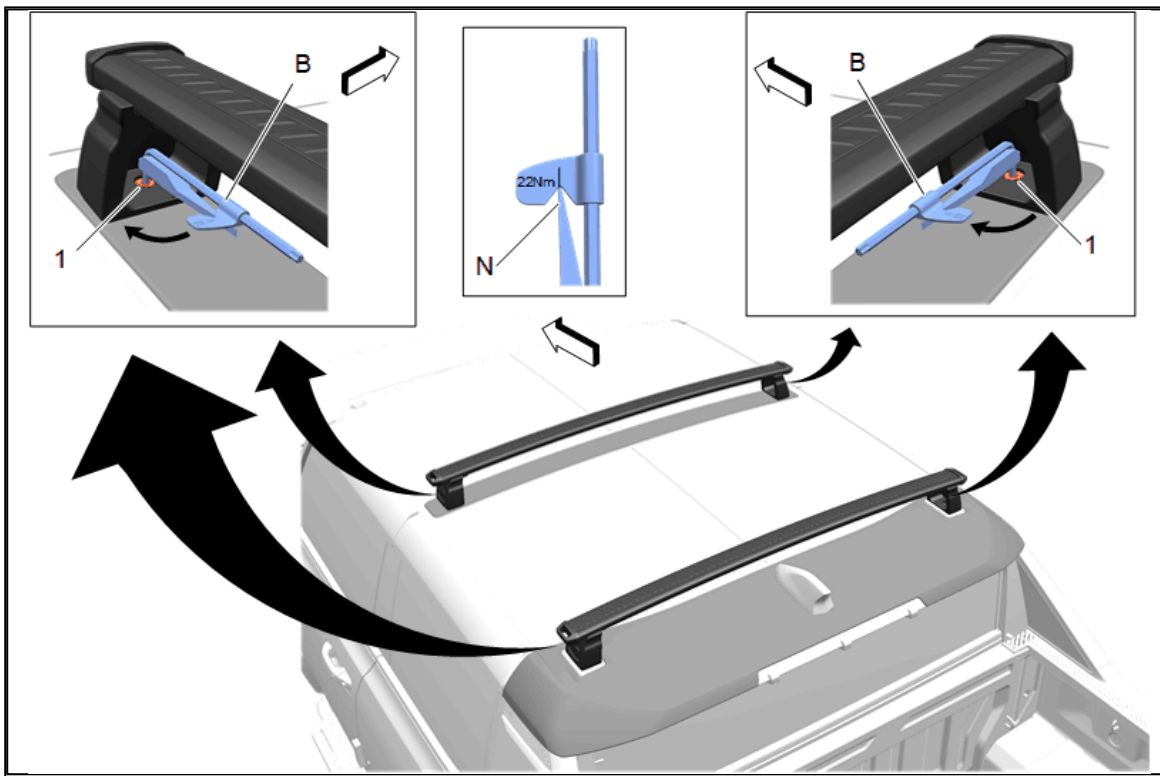

7. Tighten all 4 stanchion screws (1) using the short end of the M8 torx wrench (B) to 22 N.m (16 lb ft). Torque the Wrench (B) until the needle (N) lines up with the line to assure you have the proper torque.
8. Re-install the rear roof panel, if removed. Refer to [Roof Lift Off Panel Replacement](#) in Vehicle Service Manual.