

VIN: 1GCPTFEKXP1267895

C - Chevrolet>2023>4 - 14B - 14H43 - Colorado>06 - FRONT SUSPENSION-STEERING>(U206-008) 2023-2024 4 DRIVE SHAFT/FRONT WHEEL (ALL-WHEEL DRIVE F46)

 =  Single Use Part

U206-008 06/19/2014

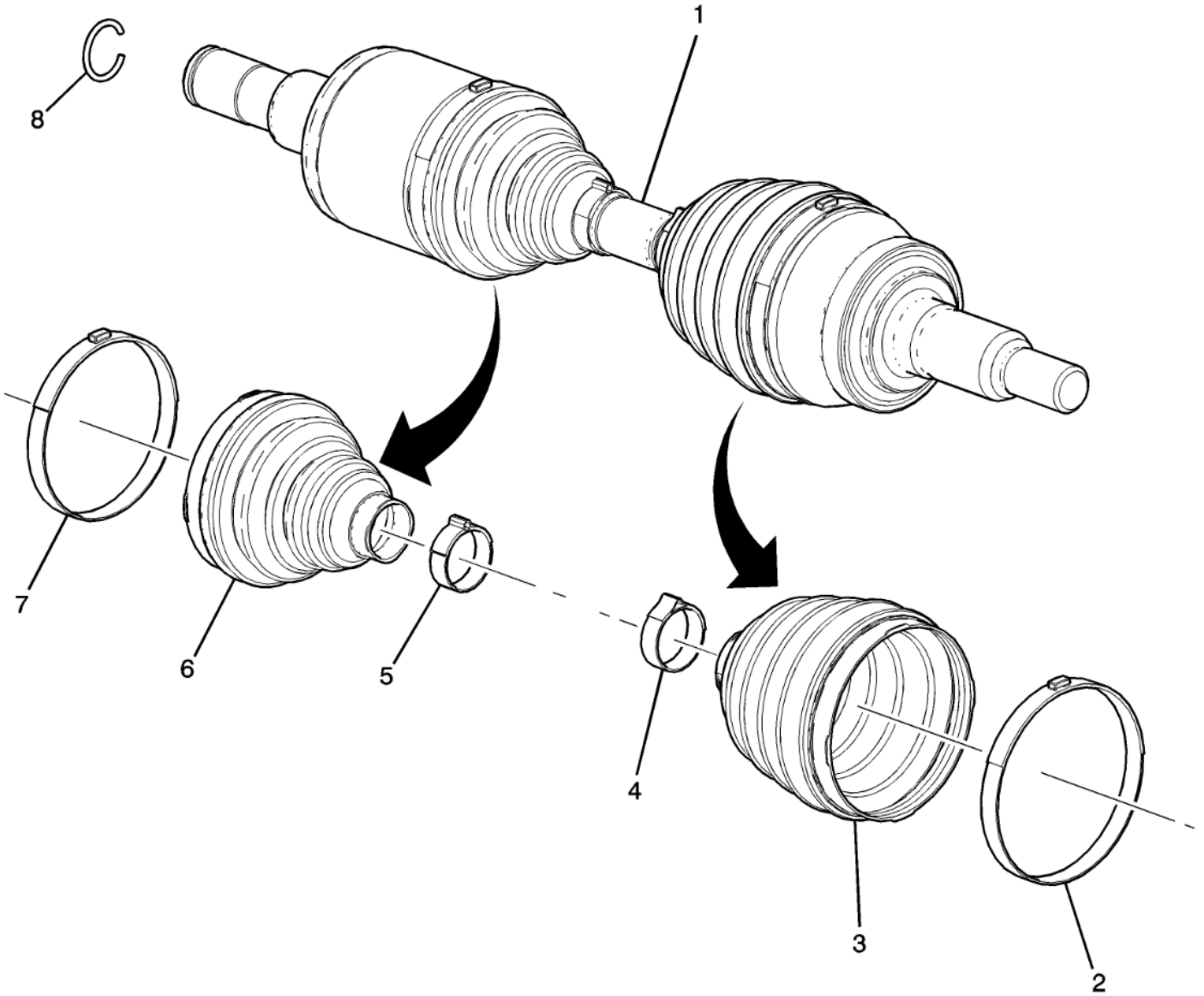

Make: Chevrolet

Year: 2023

Model: Colorado

VIN: 1GCPTFEKXP1267895

C - Chevrolet&gt;2023&gt;4 - 14B - 14H43 - Colorado&gt;06 - FRONT SUSPENSION-STEERING&gt;(U206-008) 2023-2024 4 DRIVE SHAFT/FRONT WHEEL (ALL-WHEEL DRIVE F46)

Call	Part #	Group	H	Description	Usage	Year	Qty
1	84521701	06.055		SHAFT, FRT WHL DRV HALF (INCLS 2-8) (ACDelco #84521701)	4 (43) (F46,G93)	2023 - 2024	02
2	84803136	06.061		CLAMP, FRT WHL DRV SHF CV JT OTR BOOT OTR (PART OF 1) (*KIT1) (ACDelco #84803136) (Service Lane Part)	4 (43) (F46,G93)	2023 - 2024	01
3		NS		BOOT, FRT WHL DRV SHF CV JT (PART OF 1) (*KIT1)		2023 - 2024	
4	84803137	06.061		CLAMP, FRT WHL DRV SHF CV JT OTR BOOT INR (PART OF 1) (*KIT1) (ACDelco #84803137) (Service Lane Part)	4 (43) (G93)	2023 - 2024	01
5	84926430	06.061		CLAMP, FRT WHL DRV SHF CV JT INR BOOT OTR (PART OF 1) (Service Lane Part)	4 (43)	2023 - 2024	02
6		NS		BOOT, FRT WHL DRV SHF TRI-POT JT (PART OF 1)		2023 - 2024	
7	23474667	06.061		CLAMP, FRT WHL DRV SHF CV JT INR BOOT INR (PART OF 1) (ACDelco #23474667) (Service Lane Part)	4 (43)	2023 - 2024	01
8	23474671	06.056		RING, FRT DRV AXLE INR SHF RET (PART OF 1) (ROUND CIR CLIP) (ACDelco #23474671) (Service Lane Part)	4 (43)	2023 - 2023	01
K01	84803133	06.061		BOOT KIT, FRT WHL DRV SHF CV JT (INCLS 2-4) (Service Lane Part)	4 (43) (F46,G93)	2023 - 2024	01

Make: Chevrolet

Year: 2023

Model: Colorado

VIN: 1GCPTFEKXP1267895

C - Chevrolet>2023>4 - 14B - 14H43 - Colorado>06 - FRONT SUSPENSION-STEERING>(U206-008) 2023-2024 4 DRIVE SHAFT/FRONT WHEEL (ALL-WHEEL DRIVE F46)

**Regulatory Information - Warnings displayed by Part Description**

- Part Description - SHAFT, FRT WHL DRV HALF (INCLS 2-8) (ACDelco #84521701)  
WARNING: Cancer and Reproductive Harm - [www.P65Warnings.ca.gov](http://www.P65Warnings.ca.gov)
- Part Description - CLAMP, FRT WHL DRV SHF CV JT OTR BOOT OTR (PART OF 1) (\*KIT1) (ACDelco #84803136) (Service Lane Part)  
WARNING: Cancer and Reproductive Harm - [www.P65Warnings.ca.gov](http://www.P65Warnings.ca.gov)
- Part Description - CLAMP, FRT WHL DRV SHF CV JT OTR BOOT INR (PART OF 1) (\*KIT1) (ACDelco #84803137) (Service Lane Part)  
WARNING: Cancer and Reproductive Harm - [www.P65Warnings.ca.gov](http://www.P65Warnings.ca.gov)
- Part Description - CLAMP, FRT WHL DRV SHF CV JT INR BOOT OTR (PART OF 1) (Service Lane Part)  
WARNING: Cancer and Reproductive Harm - [www.P65Warnings.ca.gov](http://www.P65Warnings.ca.gov)
- Part Description - CLAMP, FRT WHL DRV SHF CV JT INR BOOT INR (PART OF 1) (ACDelco #23474667) (Service Lane Part)  
WARNING: Cancer and Reproductive Harm - [www.P65Warnings.ca.gov](http://www.P65Warnings.ca.gov)
- Part Description - RING, FRT DRV AXLE INR SHF RET (PART OF 1) (ROUND CIR CLIP) (ACDelco #23474671) (Service Lane Part)  
WARNING: Cancer and Reproductive Harm - [www.P65Warnings.ca.gov](http://www.P65Warnings.ca.gov)
- Part Description - BOOT KIT, FRT WHL DRV SHF CV JT (INCLS 2-4) (Service Lane Part)  
WARNING: Cancer and Reproductive Harm - [www.P65Warnings.ca.gov](http://www.P65Warnings.ca.gov)